

Please check:  
 number of steps: 18  
 depth over all steps: 4248mm  
 vertical: 3190mm  
 height step 1: 175mm  
 height last step: 200mm  
 nose to nose: 5312mm

Platform Lift STRAIGHT EN81-40 compliant  
 Right hand (as viewed from lower level)  
 Platform Size: 1210x830mm  
 Platform 225kg Loading capacity  
 Powder coated in standard RAL 9006  
 Mounting: wall  
 2x Wall mounted operating unit incl. keyswitch  
 Outside installation

Platform folding support

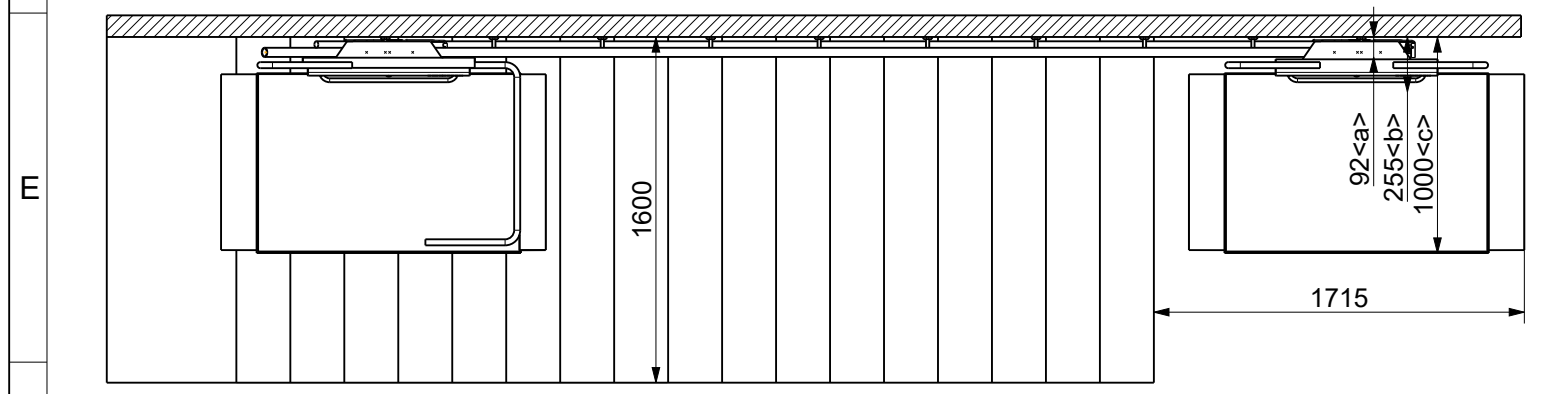
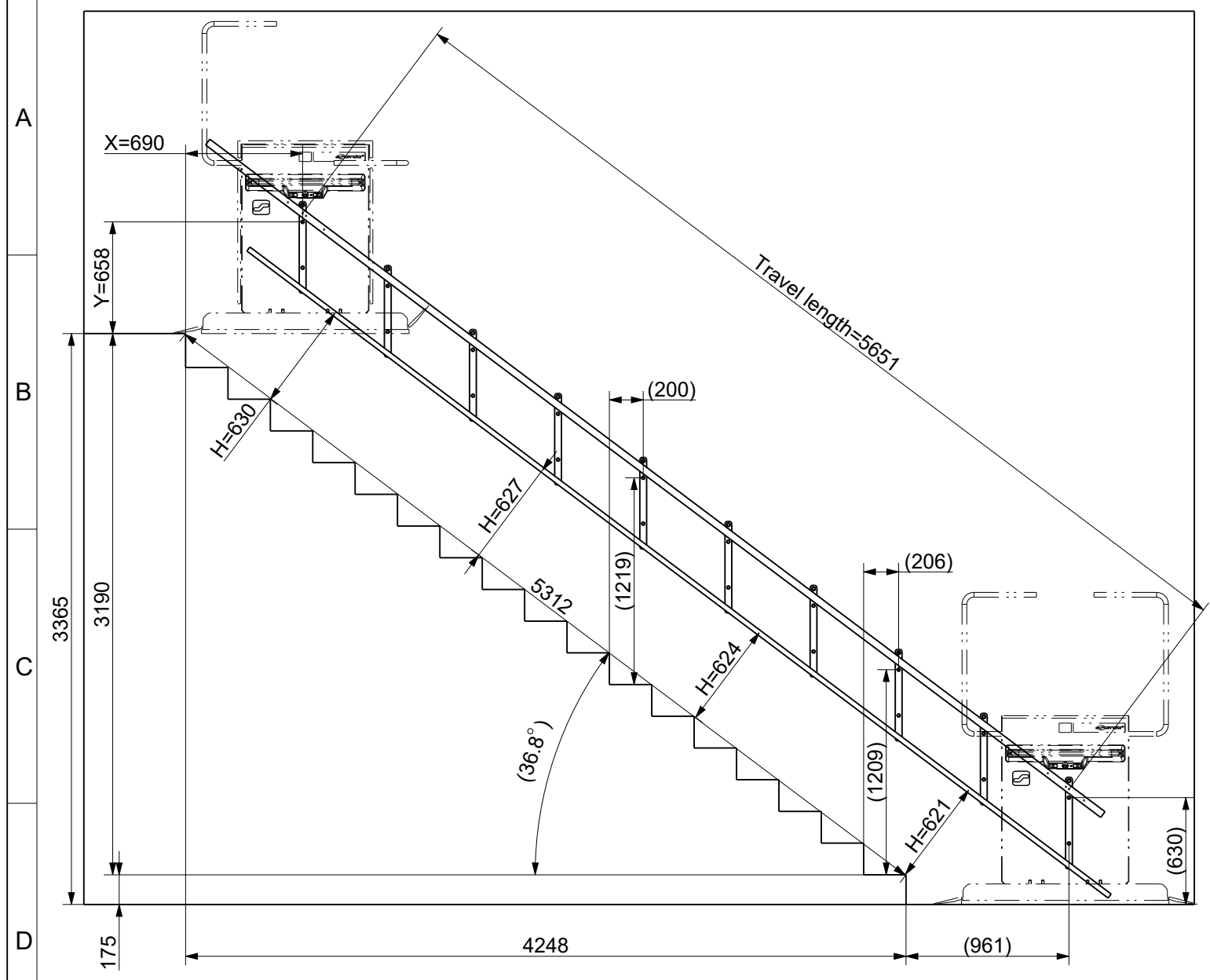
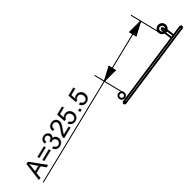

<a> ... required space rail  
 <b> ... required space Platform closed  
 <c> ... required space Platform open

				Dateityp:		
				DIN ISO	Maßstab 1:35	Gew.:192.545kg
					Benennung:	
				Name		
				Bear.	10.09.2020	Ruttmann
				Gepr.		
				Norm		
						Blatt1
						2 Bl.
Zust.	Änderung	Datum	Nam. (Urspr.)	(Ers.f.):		