

FOR THE DOOR INSTALLATION
PLEASE CONSULT THE
INSTALLATION MANUAL

PROTECTION OF THE
COMPARTMENT: NORM
UNI-EN-ISO-13857:2008
FOR PROTECTION WITH
METALLIC GRID, USE
A COMPACT MESH 12x12mm

TECHNICAL AREA
AT FLOOR "0"

PREPARE CORRUGATED
TUBE Ø10cm TO THE
TECHNICAL AREA

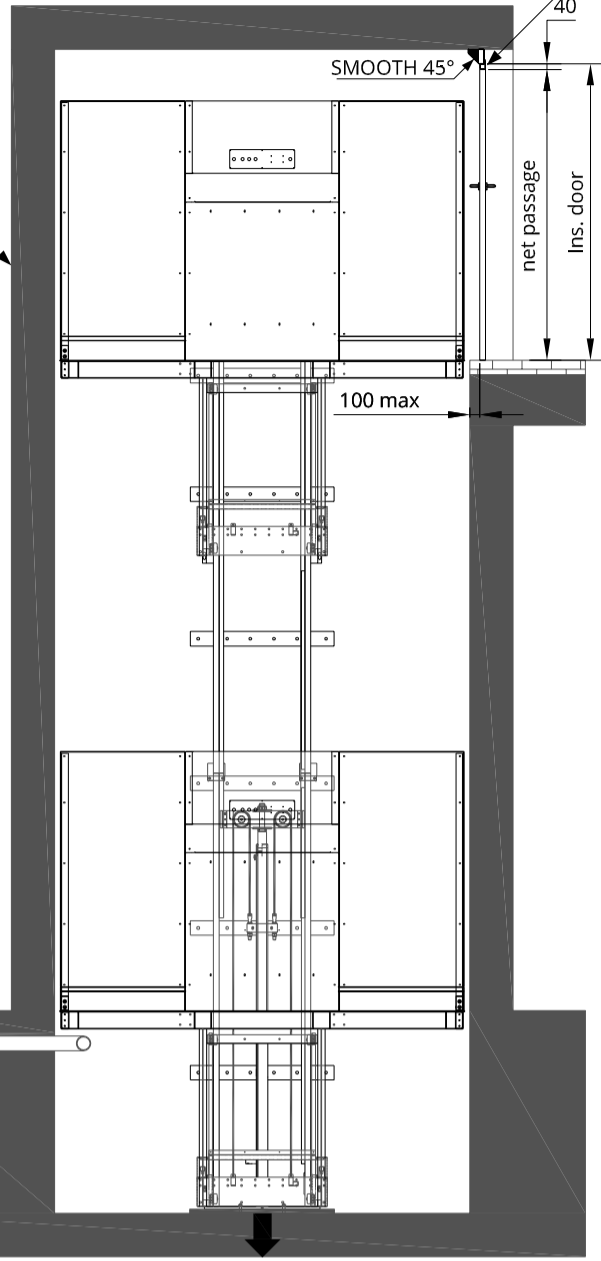

MAX DISTANCE
FROM GOODSIFT TO
TECHNICAL AREA 4MT
(L. Standard Tube = 6 mt)

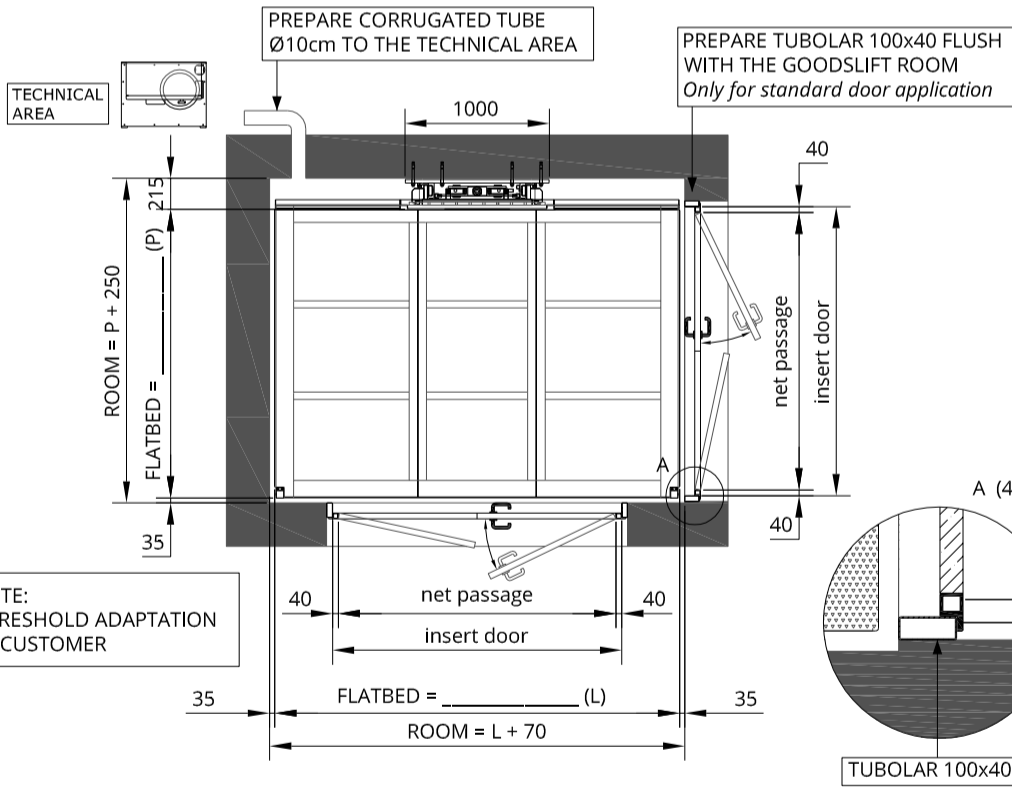
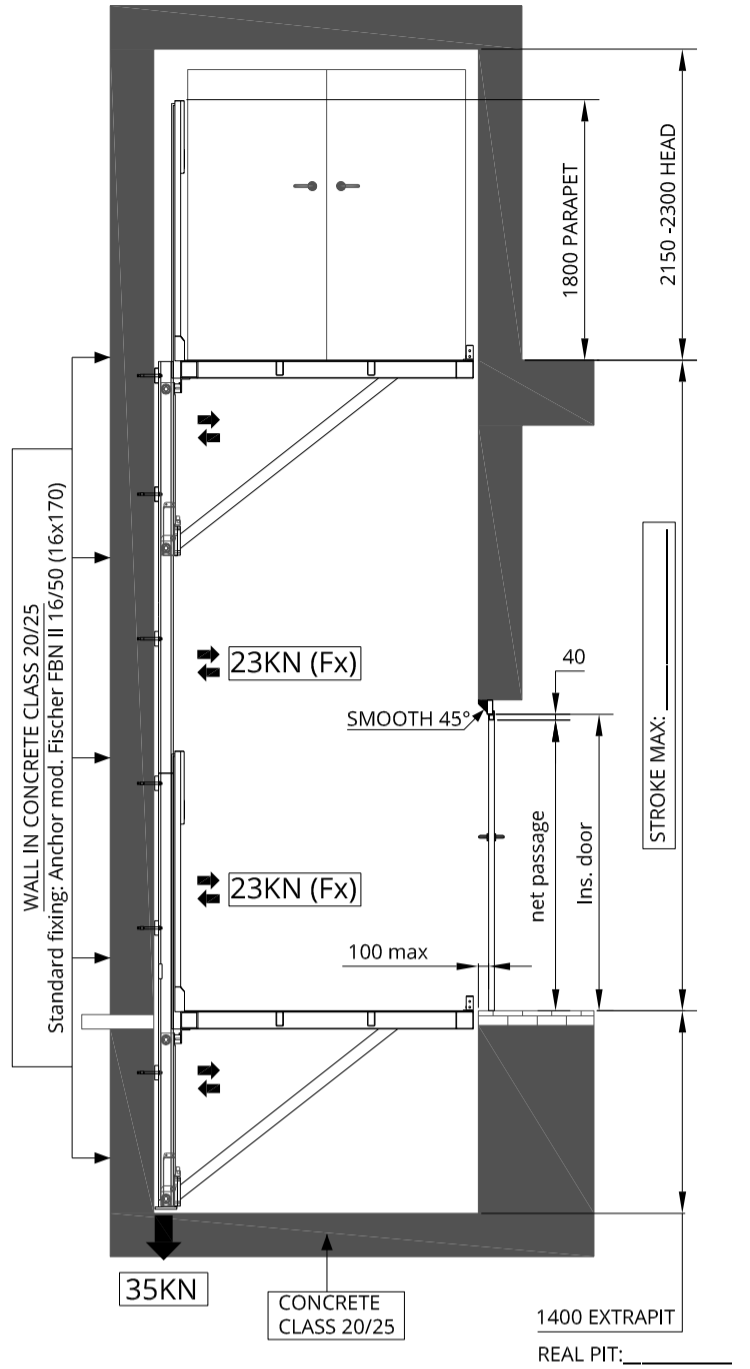

MARK THE ENTRANCES AND THE HEIGHT OF FLOOR

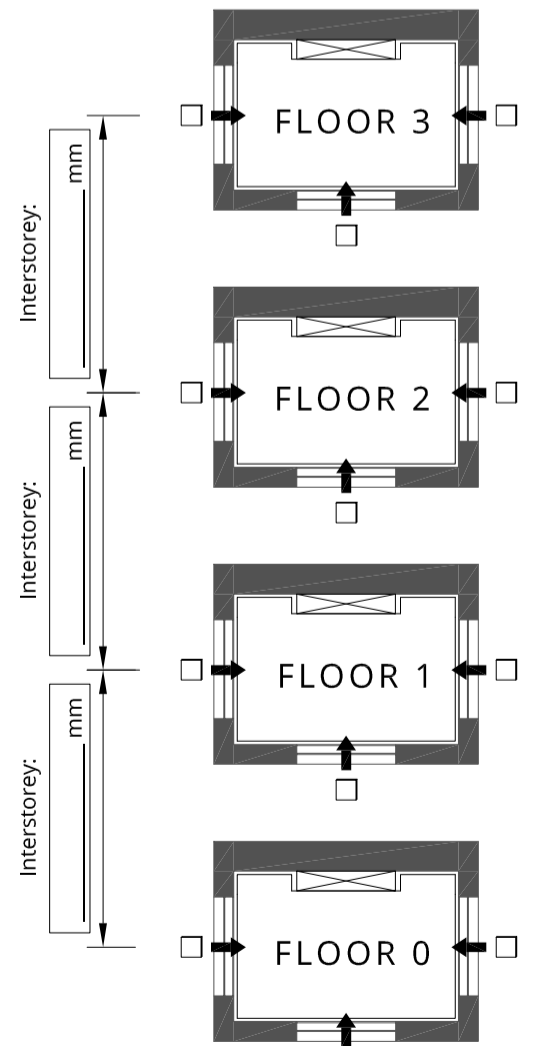

| Motore | Tensione funzionamento | Aviamento | Interruttore consigliato* | Corrente nominale | Corrente avviamento |
|--------|------------------------|-----------|---------------------------|-------------------|---------------------|
| 3kW | 220 V - trifase | Diretto | 3x16A id=0,3A | 10 | 35 |
| | 380 V - trifase | Diretto | 4x16A id=0,3A | 5 | 22 |
| 4kW | 220 V - trifase | Diretto | 3x20A id=0,3A | 16 | 50 |
| | 380 V - trifase | Diretto | 4x16A id=0,3A | 8 | 25 |
| 5,5kW | 220 V - trifase | Diretto | 4x25A id=0,3A | 22 | 60 |
| | 380 V - trifase | Diretto | 4x16A id=0,3A | 11 | 35 |

MODEL: UP10 - 1000Kg UP15 - 1500Kg

Date: _____ Signature for approval: _____



MISURE IN mm

FLATBED DIMENSION (grey area)

Force on the wall, Fx function of depth flatbed

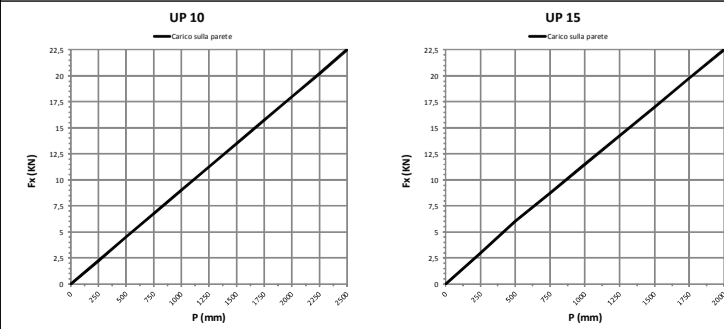
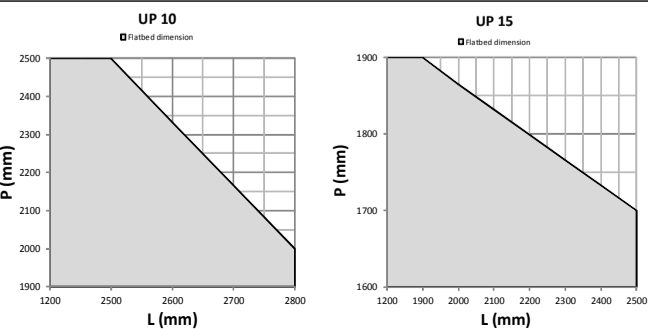

directlifts 1300 240 298 | info@directlifts.com.au | www.directlifts.com.au

Q.TA

DESCRIZIONE:

MODEL: UP10 - 1000Kg
UP15 - 1500Kg
STROKE MAX: 12000mm
WITH OPERATOR ON BOARD

Cliente: _____
Data: 07/11/14
Disegno n°:
TAV-UP1015R-SPB01
Sostituto dat: _____
Sostituisce il: _____

Formato
Foglio
A3

Scale