

FOR THE DOOR INSTALLATION  
PLEASE CONSULT THE  
INSTALLATION MANUAL

PROTECTION OF THE  
COMPARTMENT: NORM  
UNI-EN-ISO-13857:2008  
FOR PROTECTION WITH  
METALLIC GRID, USE  
A COMPACT MESH 12x12mm

TECHNICAL AREA  
AT FLOOR "0"

PREPARE CORRUGATED  
TUBE Ø10cm TO THE  
TECHNICAL AREA

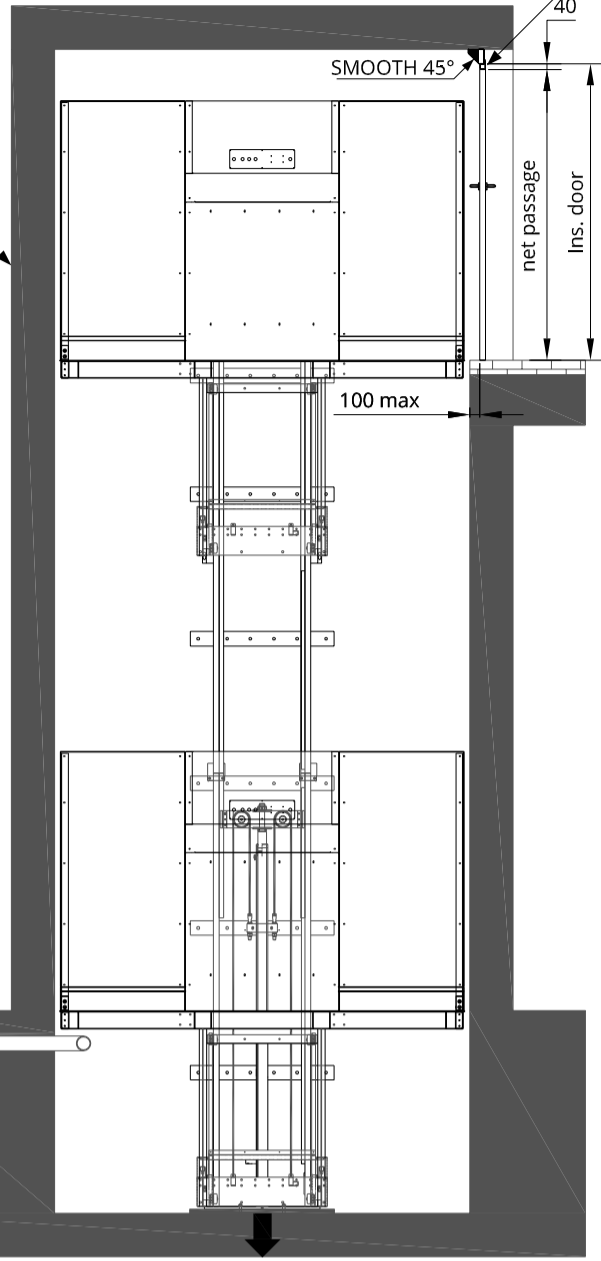

MAX DISTANCE  
FROM GOODSIFT TO  
TECHNICAL AREA 4MT  
(L. Standard Tube = 6 mt)

WALL IN CONCRETE CLASS 20/25  
Standard fixing: Anchor mod. Fischer FBN II 16x50 (16x170)

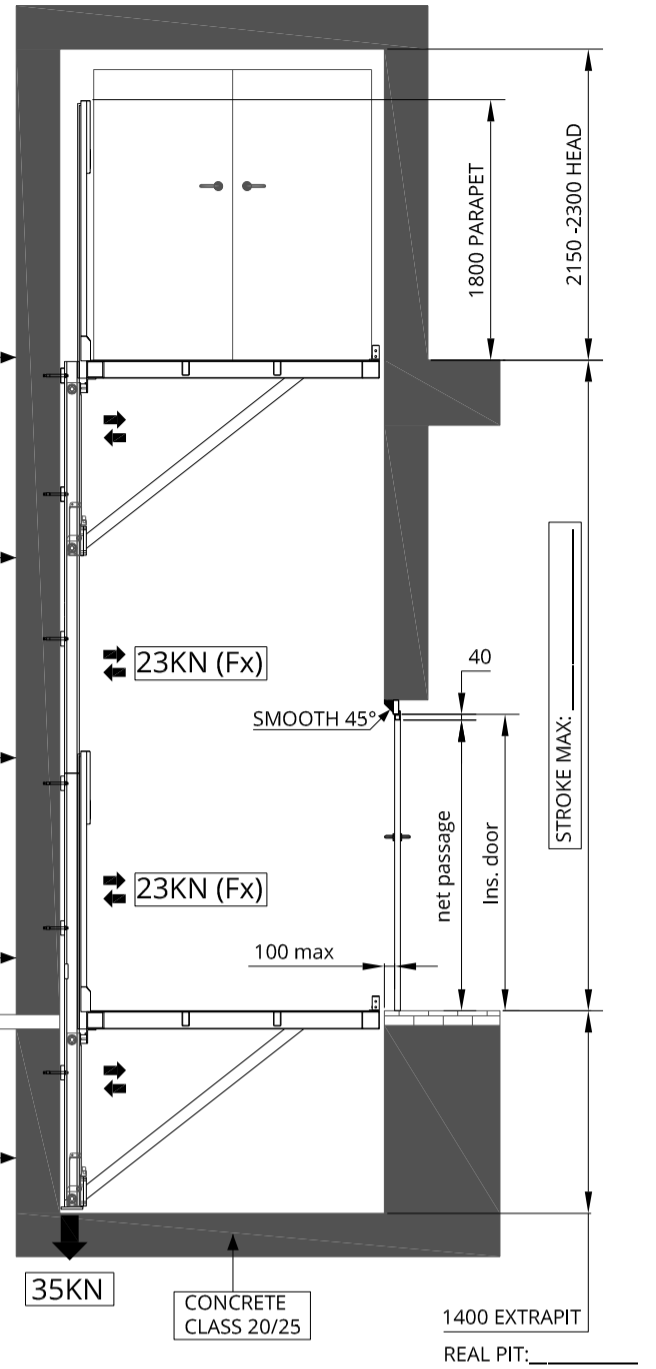

PREPARE CORRUGATED TUBE  
Ø10cm TO THE TECHNICAL AREA

PREPARE TUBULAR 100x40 FLUSH  
WITH THE GOODSIFT ROOM  
Only for standard door application

TECHNICAL AREA

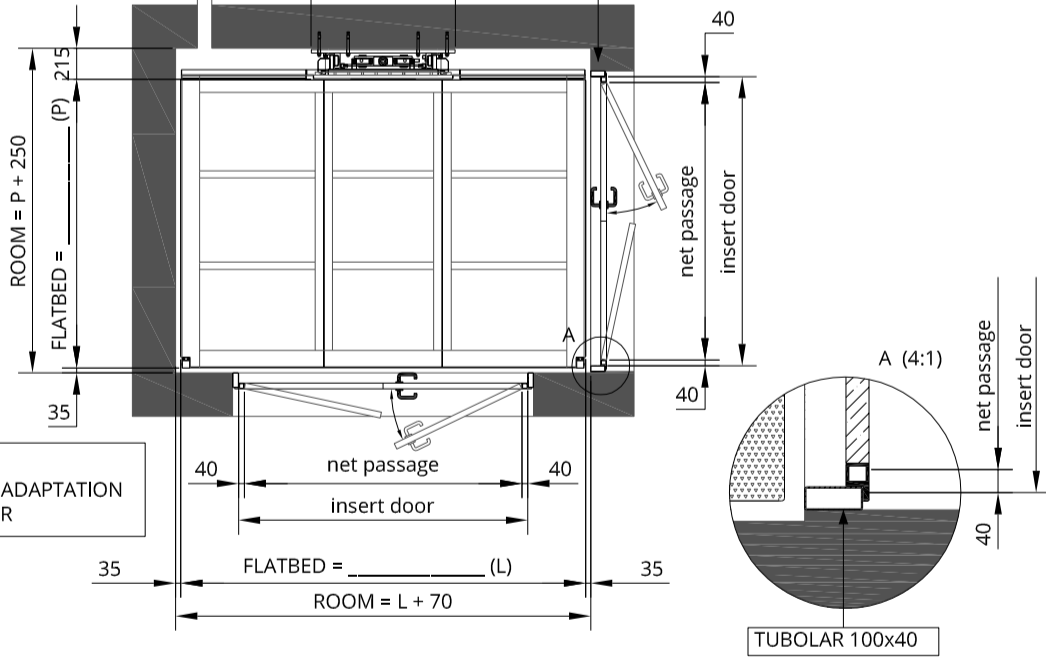

NOTE:  
THRESHOLD ADAPTATION  
BY CUSTOMER

MARK THE ENTRANCES AND THE HEIGHT OF FLOOR

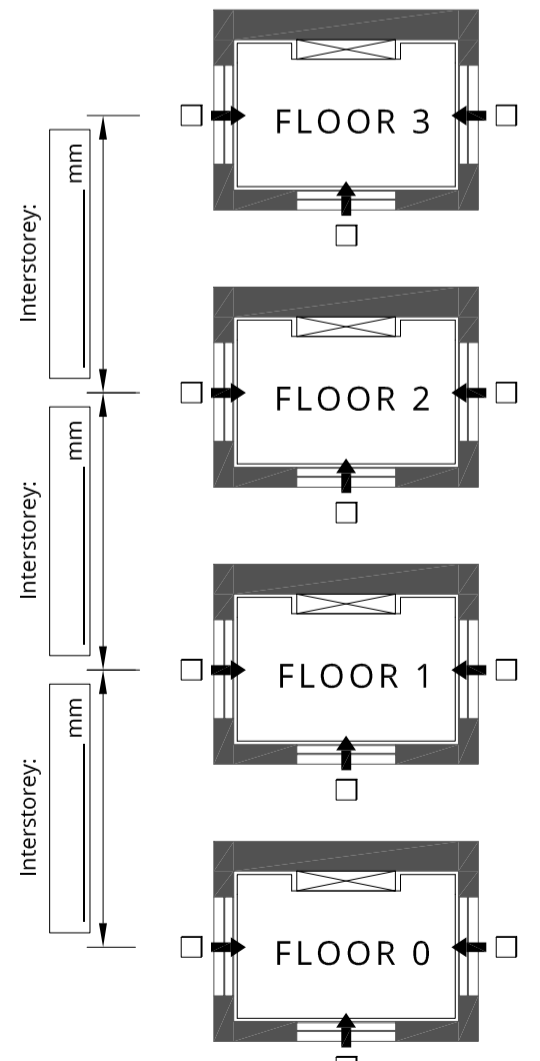

| Motore | Tensione funzionamento | Aviamento | Interruttore consigliato* | Corrente nominale | Corrente avviamento |
|--------|------------------------|-----------|---------------------------|-------------------|---------------------|
| 3kW    | 220 V - trifase        | Diretto   | 3x16A id=0,3A             | 10                | 35                  |
|        | 380 V - trifase        | Diretto   | 4x16A id=0,3A             | 5                 | 22                  |
| 4kW    | 220 V - trifase        | Diretto   | 3x20A id=0,3A             | 16                | 50                  |
|        | 380 V - trifase        | Diretto   | 4x16A id=0,3A             | 8                 | 25                  |
| 5,5kW  | 220 V - trifase        | Diretto   | 4x25A id=0,3A             | 22                | 60                  |
|        | 380 V - trifase        | Diretto   | 4x16A id=0,3A             | 11                | 35                  |

MODEL:  UP10 - 1000Kg  UP15 - 1500Kg

Date: \_\_\_\_\_ Signature for approval: \_\_\_\_\_



MISURE IN mm

FLATBED DIMENSION (grey area)

Force on the wall, Fx function of depth flatbed

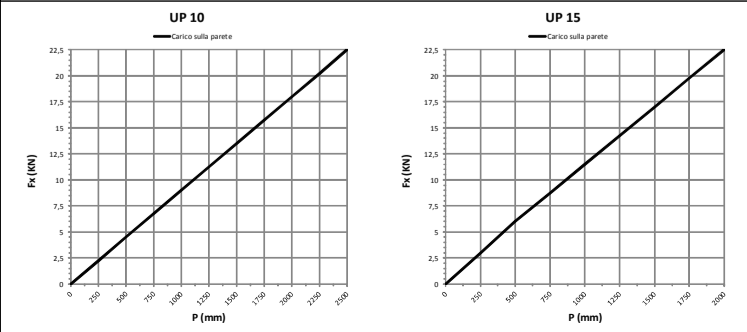
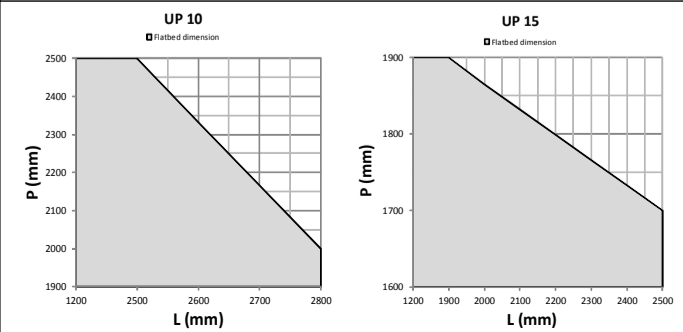

directlifts 1300 240 298 | info@directlifts.com.au | www.directlifts.com.au

Q.TA DESCRIZIONE: MODEL: UP10 - 1000Kg UP15 - 1500Kg STROKE MAX: 12000mm WITH OPERATOR ON BOARD

Cliente: \_\_\_\_\_ Data: 07/11/14

Disegno n°: TAV-UP1015R-SPB01

Sostituto dat: \_\_\_\_\_ Sostituisce il: \_\_\_\_\_